

**SPECIFICATIONS**

NAME OF OWNER: \_\_\_\_\_

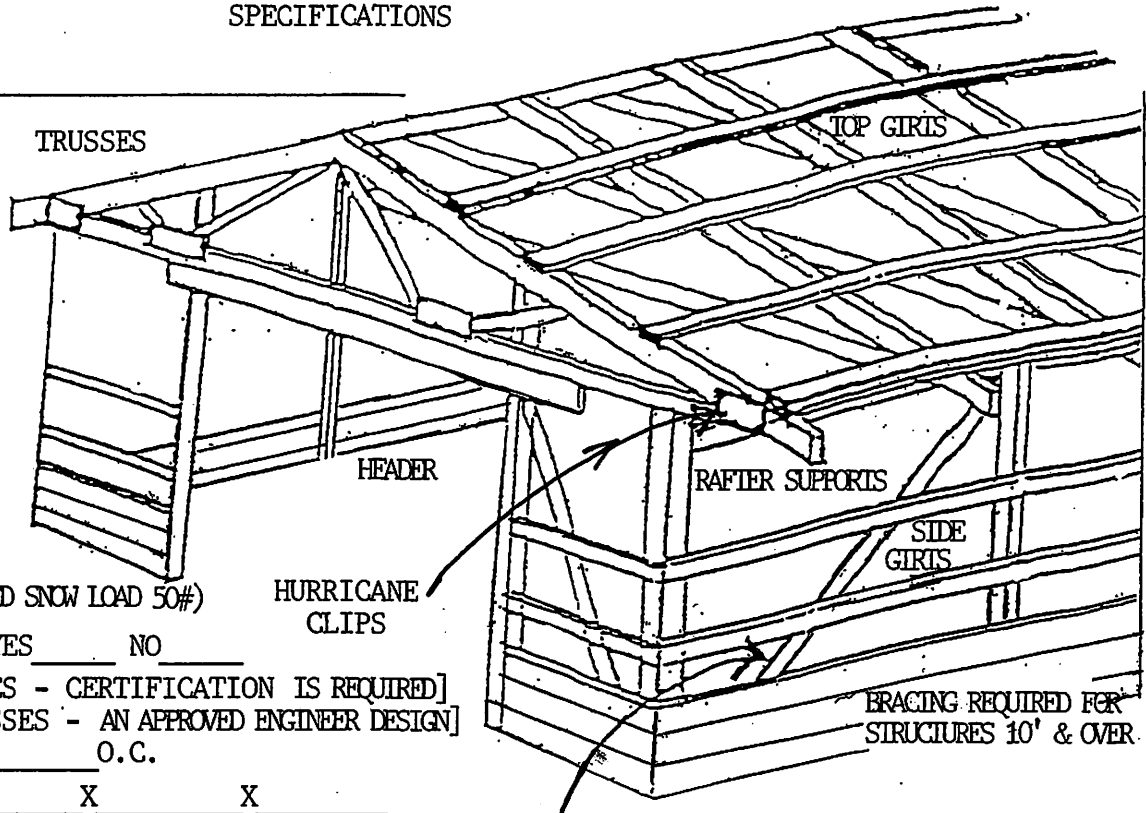
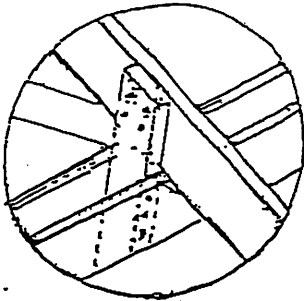

**SPECIFICATIONS:**

1. ROOF TRUSSES: (REQUIRED SNOW LOAD 50#)  
 PURCHASED TRUSSES? YES \_\_\_\_\_ NO \_\_\_\_\_  
 [FOR PURCHASED TRUSSES - CERTIFICATION IS REQUIRED]  
 [FOR OWNER BUILT TRUSSES - AN APPROVED ENGINEER DESIGN]  
TRUSS SPACING: \_\_\_\_\_ O.C.
2. BUILDING SIZE: \_\_\_\_\_ X \_\_\_\_\_ X \_\_\_\_\_  
 (WIDTH) (LENGTH) (HEIGHT)
3. POSTS: \_\_\_\_\_ SPACING \_\_\_\_\_ O.C.  
 (SIZE)
4. FOOTINGS: \_\_\_\_\_  
 [DEPTH MINIMUM: 48" OR 1/4 OF LENGTH OF POLE]
5. MAIN DOOR HEADER: \_\_\_\_\_ & \_\_\_\_\_  
 (SIZE) (SPAN)  
 BEARING \_\_\_\_\_ GABLE \_\_\_\_\_

**WIND BRACING:** WIND PRESSURE ON THE WALL WILL CAUSE THE POLES TO BEND AT THE GROUND LINE. A WIND BRACE SHOULD BE PROVIDED AT THE EAVE LINE FOR BUILDINGS WITH A SIDE HEIGHT OF OVER 10' AND FOR BUILDINGS 60' LONG AND OVER. THE BRACE SHOULD BE A 2" x 6" AT LEAST 12' LONG, EXTENDING FROM THE POLE TO THE RAFTER AT AN ANGLE OF 45° TO THE SIDE WALL.

POLE SPACING INFORMATION

| POLE SPACE | BLDG WIDTH | PAD DIAM |
|------------|------------|----------|
| 8'         | 24'        | 12"      |
| 8'         | 25'        | 16"      |
| 8'         | 30'        | 18"      |
| 8'         | 36'        | 20"      |

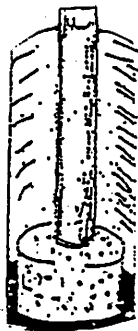

RAFTER SUPPORTS

|    |     |            |
|----|-----|------------|
| 8' | 24' | 2 - 2"x12" |
| 8' | 28' | 3 - 2"x12" |
| 8' | 38' | 4 - 2"x12" |

FASTENED WITH 2 - 1/2" CARRIAGE BOLTS

SUPPORTS FOR 8' POLE SPACING ONLY

| EAVE HEIGHT | 8' - 10' | 4" x 6" THRU 40' LENGTH | 6" x 6" THRU 60' LENGTH |
|-------------|----------|-------------------------|-------------------------|
|             | 12'      |                         |                         |

\*\*\* NOTE: NO DRY MIX - FOR PADS

CONCRETE: MINIMUM OF 8" AT BOTTOM UNDER POLES

6. TOP GIRTS: \_\_\_\_\_ X \_\_\_\_\_ & \_\_\_\_\_ O.C.
7. SIDE GIRTS: \_\_\_\_\_ X \_\_\_\_\_ & \_\_\_\_\_ O.C.
8. FLOOR: YES \_\_\_\_\_ NO \_\_\_\_\_

BRACING IN ROOF: TO PROVIDE FOR LATERAL SUPPORT OF THE TRUSSES, PROVIDE 2"x4" BRACES THE ENTIRE LENGTH OF THE BUILDING ON THE BOTTOM CHORD OF THE TRUSS.

FOR BUILDINGS UP TO 40' WIDE USE 2 SUCH BRACES AND FOR BUILDINGS 40' AND OVER USE 3 BRACES. THESE BRACES SHOULD BE LOCATED AT THE PANEL POINT ON THE LOWER CHORD.